



G A S F I R E P L A C E S

planika
INTELLIGENT FIRE

LIVING FLAME



Autumn romance inspired us to create a brand new collection.
Greatest film star legends — for impressive style and magic.

"A Farewell to Arms", 1932, directed by Frank Borzage

INDEX

G A S F I R E P L A C E S

About us	Why Planika	Technology
5	7	8-9
Safety	ECO	Valentino
11	13	15
Valentino F	Valentino LF/ FR	Valentino LF/ FR
17	18	21
Galio Strip	Galio Fire Pit Round	Technical drawings
23	25	26 - 27



ABOUT US

Planika would like to introduce you to the amazing world of modern gas fireplaces. We join the warmth of natural fire with the advanced and safe technology that Planika offers, creating unique and highly functional fire solutions.

It allows us to achieve the effect of dancing flames in their natural golden colour.

With wide expertise in designing and developing advanced fireplaces, Planika gained recognition all around the world.

Today, Planika is selling products in more than 80 countries, achieving more and more appreciation among architects and clients of the private and commercial sector.

The fireplaces are designed and developed by a professional group of engineers at Planika's laboratory, equipped with the most advanced measuring and testing instruments. Each product is carefully tested prior to selling it, ensuring the best quality and safety of Planika's fireplaces.

We do believe that Planika's success lies in our approach to fire design that is based on a constantly changing technology and solutions. It allows us to create truly advanced fireplaces.

Extensive technical knowledge and experience taught us to design every product from start to finish. By selecting the highest quality materials, components and technological solutions, Planika has come up with fireplaces that meet the most restrictive requirements of architects and designers.

To provide the finest and reliable products, our specialists constantly keep updating and modernizing the implemented technologies.

Due to this innovative approach to the needs of our customers, Planika has become the world leader in designing, manufacturing and distributing advanced automatic gas and bioethanol fireplaces for both commercial and residential spaces.

Trust our technology and find out for yourself!





WHY PLANIKA?

WHY TO CHOOSE US?

WORLDWIDE EXPERIENCE

- Over 15 years on the international market
- Leadership in the fireplace industry
- Numerous projects on every continent
- Appreciation in over 80 countries
- Top private and commercial projects (Marriott, Hilton, Kempinski and many more)

ENVIRONMENT FRIENDLY

- No harmful by-products
- No smell, smoke and ash
- Energy efficient
- Consistent heat supply
- Closed or open combustion system

CUSTOMIZATION

- Custom length and configuration
- Versatile installation options
- Designed to fit in any interior conception
- LPG or natural gas supplied
- Different finish and glazing options
- Help from the Projects Department

ADVANCED SAFETY FEATURES

- Multiple safety sensors: gas, CO and seismic activity detectors
- Child lock
- Advanced thermostat for constant heat
- Service reminder
- Automatic ignition
- Certified solutions

CONVENIENCE OF USE

- Smart Home System compatible
- Remote control
- Mobile device control (mobile application via Wi-Fi)
- 15 levels of flame height
- Eco flow mode
- Modular structure

UNIQUE DESIGN

- Anti-reflective glass
- Linear-shape/campfire / fire pit burners
- Authentic-looking decorative logs and accessories
- LED / ambient lighting
- Warm, glowing flames

TECHNOLOGY

FLUE SYSTEMS

Planika offers the best quality flue systems dedicated for gas fireplaces made of light and durable stainless steel. The installation is easy, time-saving and does not require any additional construction work, making it a practical and convenient alternative for traditional brick chimneys. All our gas fireplaces can be also connected to an existing system. Depending on specific requirements, the system also allows for installing long horizontal sections and turns at different angles. If the chimney draft is insufficient, Planika offers advanced extracting fans, installed at the end of the system. Thanks to automatic control by the fireplace, it ensures proper device operation at all times. We offer full support with the selection of all needed elements of the flue system.

BALANCED FLUE SYSTEM

A balanced flue system provides a hermetically sealed burning process. The concentric structure allows for extraction of any combustion products outside the building and supplying fresh air for the burning process at the same time. What is more, the fireplace does not affect the air in the room, providing only heat and ambient light. Due to the highest heat efficiency, it is the best system for energy-saving buildings. The solution also does not affect the supply and exhaust ventilation. The balanced flue system is a solution dedicated for Valentino and Monroe gas fireplaces.

CONVENTIONAL FLUE SYSTEM

A conventional system offers a simple installation and can be connected to an existing flue, regardless what the material it is made of. This feature makes our gas supplied products a unique alternative to replace a traditional wood-burning fireplace.

This system allows for many non-standard options and solutions for your fireplace, including fireplaces designed for specific arrangement requirements.

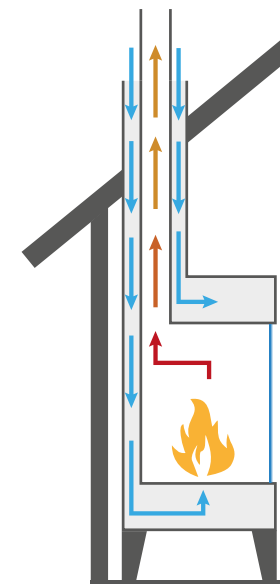

Balanced flue system

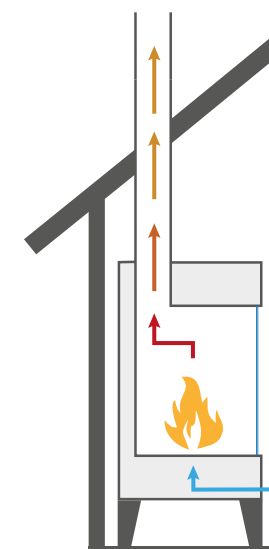

Conventional flue system



TECHNOLOGY

TWO BURNER TYPES:



A linear burner is the solution that allow us to create the long line of real fire. The sine wave-shaped flames influence the effect of unique depth of fire. The modular division makes it possible to turn on and off the side sections of the burner.



The burner that gives the fireplace the look of a traditional fireplace, but without any smoke, smell and ash. We divided the burner into two separate modules, the upper of which can be turned on and off at any time. The system of decorative logs arranged in the shape of a campfire is the solution for natural fire admirers.

CLEAN FUEL OPTIONS



Planika's advanced gas fireplaces allow for two different supply options. Choose LPG or Natural Gas and create beautiful flames in any interior.

ADVANCED THERMOSTAT



Equipped with advanced thermostats, Planika's products allow for convenient control of the temperature. The fireplace automatically regulates the flame height, maintaining the desired room temperature.

15 FLAME HEIGHTS



The flame height can be easily controlled by the user at any time. Also, the unique Eco Flow function automatically regulates the flame in the desired time-intervals, informing you about the current level of gas consumption.

REMOTE CONTROL OPTIONS

The comfort of use is yet another of our top priorities. Planika's fireplaces allow for convenient remote control options.



- The handheld remote offers convenient control of the flame and other parameters of the fireplace operation.



- Connect your gas fireplace with an advanced Smart Home System and control it from any place, anytime.



- Wi-Fi module makes it possible to control the fireplace any smart device and a mobile app. Enjoy the dancing flames from the comfort of your sofa.

HEAT INFLECTOR

Planika's gas fireplaces are equipped with a quality heat inflector that protects TV and other sensitive items from absorbing excessive heat and reduce the temperature, improving its overall performance.



SAFETY

BURNING CONTROL SYSTEM



The advanced electronic components combined with multiple safety sensors, monitor the operation of the fireplace and turn the device off in case any disfunction is detected.

- a) CO detector - an advanced safety feature aiming to **detect any leak** in the flue system
- b) Gas detector - in case any gas leaks are detected, the main valve is dosed, turning the fireplace off immediately
- c) Seismic activity sensor - to ensure the highest level of safety, the fireplace is automatically deactivated if any shakes **is** detected

FLAME CONTROL



An ionizing electrode controls the flame - should it unexpectedly go out, the gas supply will be automatically disconnected.

CHILD LOCK



In order to be turned on, the device requires a fixed sequence of buttons to be pushed. This feature minimizes the risk of unwanted activation of the fireplace.

CERTIFIED CONSTRUCTION



Planika's products and components have successfully passed extensive tests carried out by the leading certification institutes meeting the most demanding European safety and quality requirements.

SERVICE REMINDER



Once a year, the fireplace should be for scheduled service. The **service** helps to maintain proper device operation at all times.





ECO

ECO FLOW FUNCTION



Planika introduces Eco Flow, a function reducing gas consumption without losing the natural look of the fire. Eco Flow regulates the flame height over time based on the pattern set by the user through the application.

MODULAR BURNER



Most of Planika's gas fireplaces are equipped with multiple burners. The user can turn off a section of the fireplace, saving up to 50% of gas, without losing the unique ambience of golden flames.

SPACE HEATING



A gas fireplace is not just a decoration - a room can be heated up by the warm air discharged from the furnace through two concentrating additional pipes. It does not include exhaust gases or pollution – it is a natural, clean source of heat. The ambient temperature is also increased due to the emission of heat through the glass, obscuring the flame. The combination of these two systems allows to achieve outstanding results and quickly warm a cold room.

PERFECT FOR BUILDINGS WITH HEAT RECOVERY VENTILATION

A gas fireplace with closed combustion ensures the highest level of thermal comfort. It is the perfect solution for buildings with heat recovery ventilation (HRV), since it does not interrupt the operation of the system.



ECO FUEL



Switch to green energy today! Both LPG and Natural Gas are an environment-friendly fuel, providing you with a clean source of energy. As opposed to wood and biomass, it does not produce any smoke, soot, smell, ash and hazardous gasses.



VALENTINO

G A S F I R E P L A C E S

Valentino combines all the features of a modern and advanced gas fireplace. With the most natural-looking ceramic logs, decorative elements and beautifully natural flames, Valentino is a perfect alternative for traditional wood-burning fireplaces.

The engineers of Planika equipped the fireplace with multiple safety features, guaranteeing always proper operation of the device. The advanced gas and CO sensors detect leaks in the flue and gas installation as well as any potential rise of the carbon monoxide level. The seismic activity sensor and child lock mode provide even more safety for you and your family.

Thanks to the applied technological solutions, Valentino allows for a significant reduction of gas consumption (Eco Flow mode and the possibility of disconnecting sections of the burner). The fireplace can be controlled with a handheld remote, Smart Home System and mobile devices with a dedicated application. Such an exclusive feature brings your comfort to another level.

Diversified glazing options and a long line of fire allow for arranging Valentino in all kinds of interiors.

The fireplace is offered in two standard lengths, each in four different versions of anti-reflective glass.

Available anti-reflective glazing options:

Valentino F glazing on one side (front)

Valentino LF glazing on two sides (left, front)

Valentino FR glazing on two sides (front, right)

Valentino LFR glazing on three sides (left, front, right)



VALENTINO F

FRONT GLAZING 1000 / 1300



FEATURES:

Linear-shape burner
Anti-reflective glass - front
LPG / Natural Gas powered
CO detector
Gas detector
Seismic activity sensor
Child lock
Advanced thermostat
Service reminder

Remote control
Smart Home System compatible Wi-Fi
(mobile device control)
15 levels of flame height
Eco flow mode
Modular burner
Natural-looking accessories
Heat inflector

TECHNICAL DATA:

Front glass length [mm]	1000		1300	
Fuel option	Natural gas (G20/G25)	LPG (G30/G31)	Natural gas (G20/G25)	LPG (G30/G31)
Nominal Heat Output [kW]	6,4	6,7	8,5	7,4
Nominal Heat Input (Hi) [kW]	8,5	8,9	11,3	9,9
Gas consumption [m³/h]	0,25-0,9	-	0,29-1,2	-
Gas consumption [kg/h]	-	0,2-0,7	-	0,2-0,78
Interior	Matt black painted steel / optional rear lining: black ceramic glass (high gloss)	Matt black painted steel / optional rear lining: black ceramic glass (high gloss)	Matt black painted steel / optional rear lining: black ceramic glass (high gloss)	Matt black painted steel / optional rear lining: black ceramic glass (high gloss)
Flue system [mm]	Concentric flue 200/130	Concentric flue 200/130	Concentric flue 200/130	Concentric flue 200/130



VALENTINO LF/FR

LEFT / FRONT OR FRONT / RIGHT GLAZING

1000 / 1300



FEATURES:

Linear-shape burner
Anti-reflective glass - left/front or front/
right
LPG / Natural Gas powered
CO detector
Gas detector
Seismic activity sensor
Child lock
Advanced thermostat
Service reminder

Remote control
Smart Home System compatible
Wi-Fi (mobile device control)
15 levels of flame height
Eco flow mode
Modular burner
Natural-looking accessories
Heat inflector

TETECHNICAL DATA:

Front glass length [mm]	1000		1300	
Fuel option	Natural gas (G20/G25)	LPG (G30/G31)	Natural gas (G20/G25)	LPG (G30/G31)
Nominal Heat Output [kW]	6,4	6,7	8,5	7,4
Nominal Heat Input (Hi) [kW]	8,5	8,9	11,3	9,9
Gas consumption [m³/h]	0,25-0,9	-	0,29-1,2	-
Gas consumption [kg/h]	-	0,2-0,7	-	0,2-0,78
Interior	Matt black painted steel / optional rear lining: black ceramic glass (high gloss)	Matt black painted steel / optional rear lining: black ceramic glass (high gloss)	Matt black painted steel / optional rear lining: black ceramic glass (high gloss)	Matt black painted steel / optional rear lining: black ceramic glass (high gloss)
Flue system [mm]	Concentric flue 200/130	Concentric flue 200/130	Concentric flue 200/130	Concentric flue 200/130

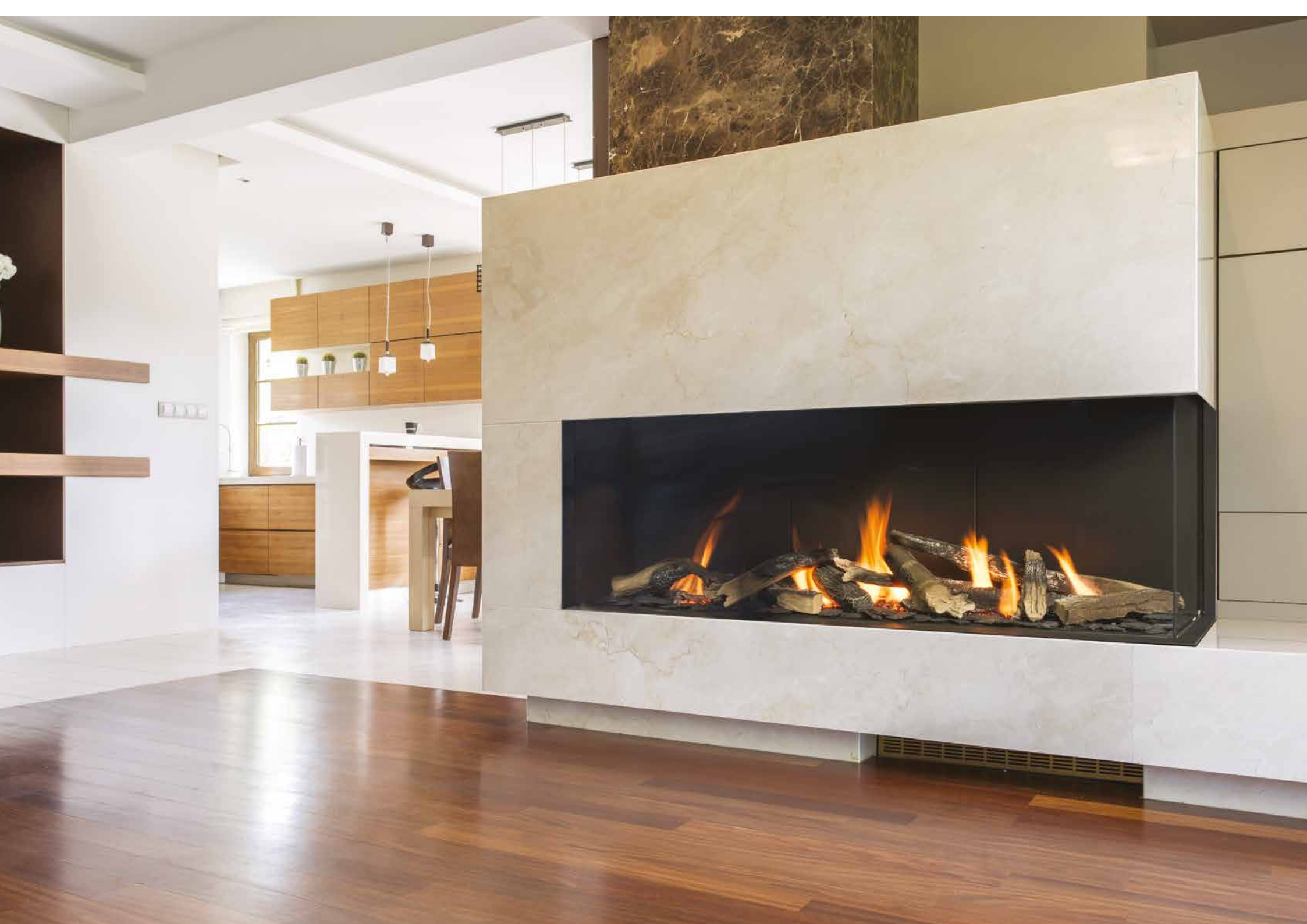

VALENTINO LF/FR

LEFT / FRONT OR FRONT / RIGHT GLAZING

1000 / 1300



FEATURES:

Linear-shape burner
Anti-reflective glass - left/front or front/right
LPG / Natural Gas powered
CO detector
Gas detector
Seismic activity sensor
Child lock
Advanced thermostat
Service reminder

Remote control
Smart Home System compatible
Wi-Fi (mobile device control)
15 levels of flame height
Eco flow mode
Modular burner
Natural-looking accessories Heat inflector

TECHNICAL DATA:

Front glass length [mm]	1000		1300	
Fuel option	Natural gas (G20/G25)	LPG (G30/G31)	Natural gas (G20/G25)	LPG (G30/G31)
Nominal Heat Output [kW]	6,4	6,7	8,5	7,4
Nominal Heat Input (Hi) [kW]	8,5	8,9	11,3	9,9
Gas consumption [m³/h]	0,25-0,9	-	0,29-1,2	-
Gas consumption [kg/h]	-	0,2-0,7	-	0,2-0,78
Interior	Matt black painted steel / optional rear lining: black ceramic glass (high gloss)	Matt black painted steel / optional rear lining: black ceramic glass (high gloss)	Matt black painted steel / optional rear lining: black ceramic glass (high gloss)	Matt black painted steel / optional rear lining: black ceramic glass (high gloss)
Flue system [mm]	Concentric flue 200/130	Concentric flue 200/130	Concentric flue 200/130	Concentric flue 200/130



GALIO CORTEN

O U T D O O R

Galio Corten is a linear gas fireplace that creates a cosy and unique atmosphere in every kind of outdoor living space. Its design and portable, freestanding form bring the beauty and warmth of fire combined with many arrangement possibilities. Made of weather resistant materials, Galio Corten guarantees to deliver style and taste to every residential and commercial outdoor space throughout the whole year.

The length of a single module of Galio Corten fireplace can be customized in the range between 800 mm up to 2000 mm. Thanks to the exceptional design and long line of real fire, Galio awakens the atmosphere of any garden, patio or terrace.



Optional remote control

FEATURES:

Linear burner
LPG/Natural Gas powered
For outdoor use
Intuitive control panel
Flame height regulation
Custom length

Easy installation
No electrical connection
Portable form
Decorative Black Diamond stones
SHS compatible

Finish:

CASING: core ten steel
GLASS SHIELD: tempered glass
BURNER: stainless steel

TECHNICAL DATA:

Net weight: 31 kg / 68 lbs

LPG

Heat output:

min.: 6,3 kW (21 623 BTU) ; max.: 11,8 kW (40 219 BTU) Gas rate:

min.: 0,5 kg/h (1,1 lbs/h); max.: 0,93 kg/h (2,05 lbs/h) Gas

pressure: 37 mbar / 11 WC

NG

Heat output:

min.: 4,7 kW (16 108 BTU); max.: 9,4 kW (32 215 BTU) Gas rate:

min.: 0,5 m³/h (17,7 ft³/h); max.: 1,0 m³/h (35,3 ft³/h) min.: 1,2 lbs/h; max.: 2 lbs/h

Gas pressure: 20 mbar / 7 WC



GALIO FIRE PIT CORTEN

O U T D O O R

Galio Corten Fire Pit is an automatic outdoor gas fireplace enclosed in a round, puristic case resistant to the most severe weather conditions. Exposed to the outside environment, the steel develops a rusty in appearance oxide layer. All of this make it a safe and durable fireplace for your garden or terrace.

Its heart – the unique fire-pit-shape burner – creates an even and concentrated flame that will bring every outdoor space to life. The fireplace can also be fitted with an optional glass cylinder which covers the flame and provides an additional aesthetic value.

Galio Corten Fire Pit is a free-standing, portable product. This feature allows for easy installation and free arrangement of the fireplace (no electric connection required). Two control solutions, an integrated Easy Start panel and optional handheld remote offer extra comfort and easy control of the device and the flame. Together with safe, low voltage and two fuel options (Natural Gas or LPG), Galio Corten Fire Pit is the ideal fireplace for outdoor spaces of any kind.



Optional remote control

FEATURES:

- Round burner
- LPG/Natural Gas powered
- For outdoor use
- Intuitive control panel
- Flame height regulation
- Custom size

- No electrical connection
- Portable form
- Decorative Black Diamond stones
- SHS compatible
- Optional glass cylinder

Finish:

- CASING: corten steel
- BURNER: stainless steel

TECHNICAL DATA:

Net weight: 65 kg / 143 lbs

LPG

Heat output:

min.: 2,5 kW (8 649 BTU); max.: 5,1 kW (17 299 BTU) Gas rate:

min.: 0,2 kg/h (0,44 lbs/h); max.: 0,4 kg/h (0,88 lbs/h) Gas

pressure: 37 mbar / 11 WC

NG

Heat output:

min.: 2,4 kW (8 054 BTU); max.: 4,7 kW (16 108 BTU) Gas rate:

min.: 0,25 m³/h (8,8 ft³/h); max.: 0,5 m³/h (17,7 ft³/h) Gas

pressure: 20 mbar / 7 WC

VALENTINO

TECHNICAL DRAWINGS

Valentino - F 1000

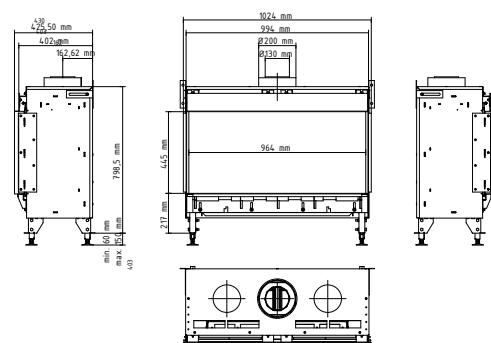

Valentino - LF 1000

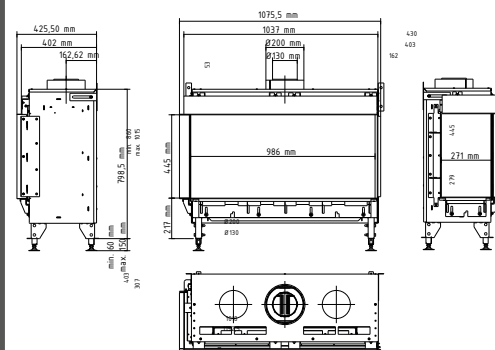

Valentino - FR 1000

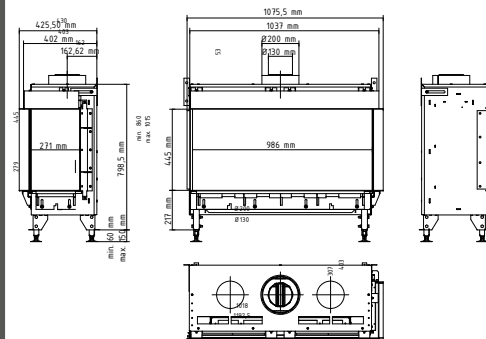

Valentino - LFR 1000

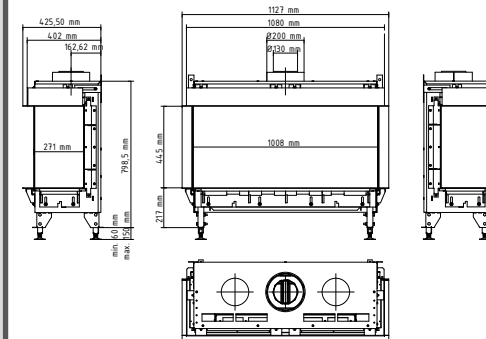

Valentino - F 1300

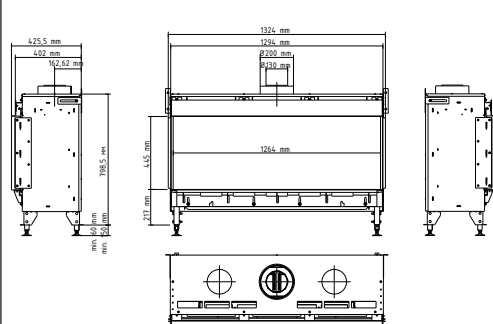

Valentino - LF 1300

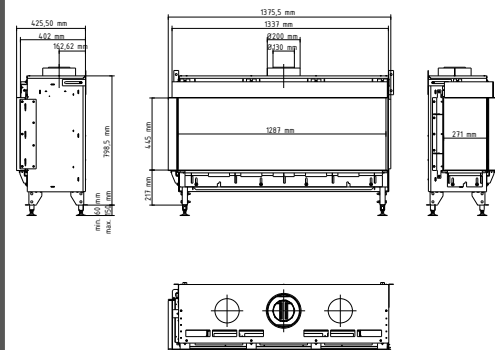

Valentino - FR 1300

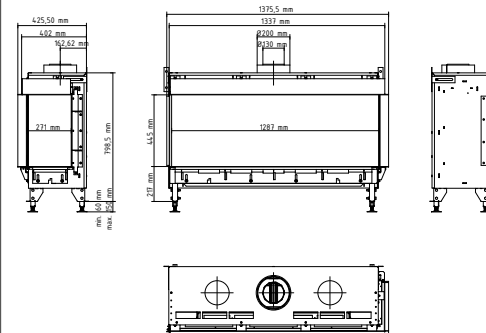

Valentino - LFR 1300

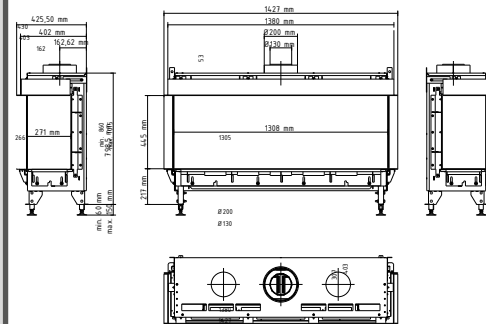

OUTDOOR

TECHNICAL DRAWINGS

GaLio Corten

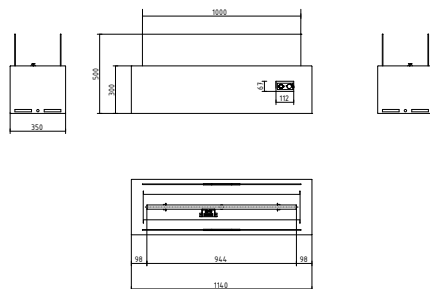

GALIO FIRE PIT CORTEN

GaLio Insert

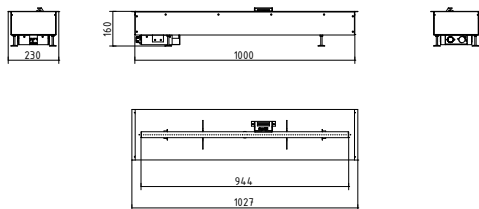

GALIO FIRE PIT INSERT



The 20th century was our source of inspiration for an attractive,
comfortable and safe collection.

~Planika